

# BRAMBLE



## FOR SALE



PRICE:  
**£64,995**

**54FT // 2005**  
Semi Trad Narrowboat

**4 BERTH**

### BOAT SUMMARY

Bramble is a beautifully presented narrowboat full of character. She is well equipped with a Refleks diesel stove, central heating and Victron inverter. Bramble has been well maintained and lovingly cared for and is ideal for either liveaboard or leisure cruiser.

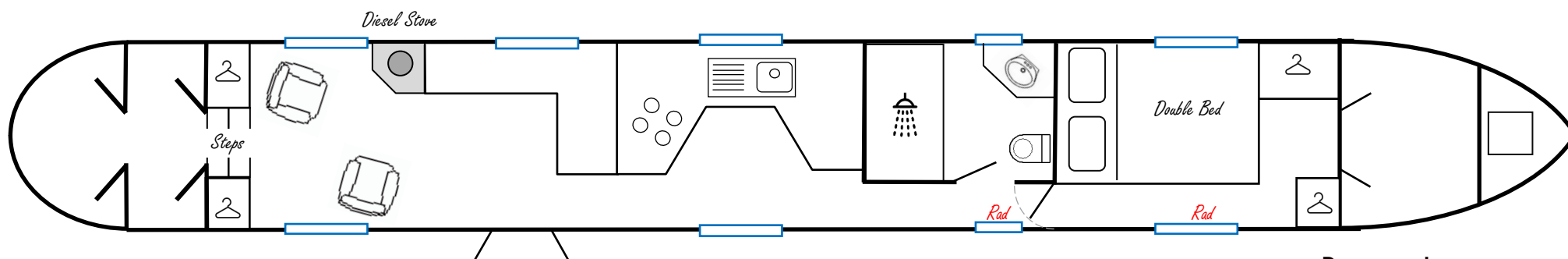

Reverse Layout



THE ASHBY CANAL CENTRE  
WILLOW PARK MARINA  
STOKE GOLDING  
NUNEATON  
WARWICKSHIRE  
CV13 6EU

BRIDGE 26, THE ASHBY CANAL

CONTACT US FOR A VIEWING

**01455 212636**

[boatsales@ashbycanalcentre.co.uk](mailto:boatsales@ashbycanalcentre.co.uk)

# SPECIFICATIONS

ashbycanalcentre.co.uk

## GENERAL

- Year Built: 2005
- Builder: Southwest Durham Steel Craft (Castle Class)
- Length: 54'
- Style: Semi Trad
- Reverse Layout
- Berth: 4
- Headroom: 6'3" in centre
- Steel Thickness 10/6/ 4
- Engine: Beta 35
- Gearbox: PRM 150
- Hospital Silencer
- Twin Alternator
- Ash Lining
- Laminate Flooring

## ELECTRICAL

- 12V Starter Battery (Oct 21)
- 4x110ah 12V Leisure Batteries
- Victron 1600W Inverter Charger
- Shoreline Socket
- Bilge Pump
- Victron MPPT Controller and Solar Panels
- 12V LED Lighting (March 20)
- 12V and 240V Sockets (March 20)

## HEATING

- Reflek Diesel Stove
- Two Radiators to Bathroom and Bedroom)
- Spray Foam Insulation
- Wiring for storage heaters

## WATER/GAS SYSTEM

- 600Ltr Stainless Steel Tank
- Calorifier with Immersion Heater
- Jabsco Water Pump
- 2 x 13Kg Gas Bottles

## KITCHEN

- Country Leisure Cooker / Grill
- Country Leisure 4 Gas Hob
- 12V LEC Inlander Fridge (May 21)
- Stainless Steel Sink
- Drop Leaf Breakfast Bar
- Laminated Worktop
- Good Storage

## LIVING/DINING

- L Shape Dinette (converts to double) with Desmo Table
- Storage Under
- 2 Camden Chairs w/ Walnut Legs
- Cupboards
- 12V TV mounted to Wall

## BATHROOM

- Dometic Pump Out Toilet
- Ceramic Sink with vanity unit
- Hip Bath with Shower over
- Shaver Point

## BEDROOM

- Double bed with storage under
- Large Wardrobe and Cupboard
- Storage over Bed

## DECKS

- Seating and storage to front and rear
- Front Cratch Cover with Windows
- Rear Pram Cover (June 20)
- Side Cleats and centre ropes

## MAINTENANCE

- Blacked October 2021
- New Side Anodes 2021
- Full Engine Service Nov 2021
- New lift Pump, alternator and control panel 2021
- Boat Safety expires Feb 2023
- Stove / Central Heating serviced Feb 2022



These details are given in good faith but no guarantee is given or implied. Purchasers must satisfy themselves as to the condition and suitability of this vessel. We recommend that a qualified surveyor is employed. The Ashby Canal Centre are agents for this boat on behalf of the owner



