

LEDAIG

FOR SALE



PRICE:

£49,995

70FT // 2003

2 Berth / Cruiser Stern
Reverse Layout

SUMMARY

Ledaig is a beautifully crafted and exceptionally spacious 70-foot narrowboat, built by Measham Boats. Designed with a reverse layout, this boat offers an ideal setup for comfortable liveaboard living, featuring a generous open-plan living space and the potential to create two separate bedrooms.

Equipped with a range of onboard appliances, Ledaig includes a Shoreline fridge/freezer, Zanussi washer-dryer, AEG dishwasher, and a Morso stove with back boiler—perfect for all-season cruising and living.

A recent hull survey conducted in December 2024 confirmed the boat's good condition, giving you peace of mind and readiness for your next adventure.

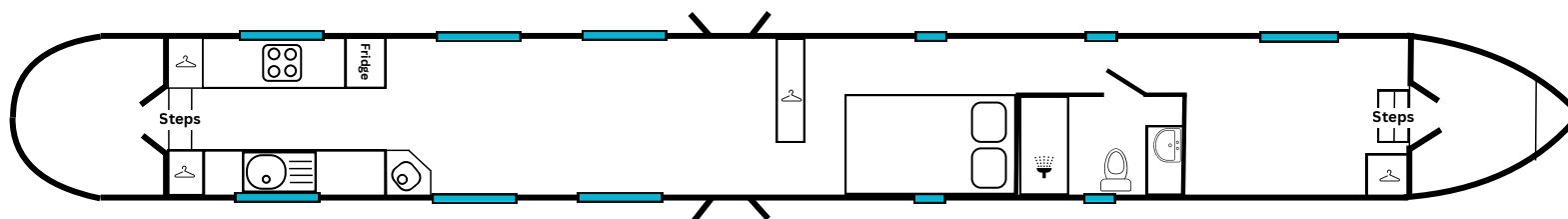

THE ASHBY CANAL CENTRE, WILLOW PARK MARINA, STOKE GOLDING,
NUNEATON, WARWICKSHIRE, CV13 6EU

CONTACT US FOR A VIEWING

01455 212636

boatsales@ashbycanalcentre.co.uk

LEDAIG SPECIFICATION

GENERAL

- YEAR BUILT: **2003**
- BUILDER: **MEASHAM BOATS**
- STYLE: **CRUISER STERN**
- BERTH: **2**
- LENGTH: **70'**
- HEADROOM: **200cm in Centre**
- ENGINE: **2202 BARRUS SHIRE**
- GEARBOX: **PRM150**
- ALTERNATOR: **TWIN + 240V POWER PACK ALTERNATOR**
- RCD: **NO**
- **VETUS BOW THRUSTER**

ELECTRICAL

- 12V Starter Battery
- 2 x 110Ah Leisure Batteries
- 2.5KW Inverter
- 2 x 215W Solar Panels
- Victron 12/30 Charger
- Shoreline Socket
- Electrolux Travel Power 3.5Kw
- Galvanic Isolator
- Bilge Pump

HEATING

- Morso Multifuel Stove
- Back Boiler with 4 x Radiators
- Spray Foam Insulation

WATER/GAS

- Stainless Steel Water Tank
- Jabsco Par Max Water Pump
- 13Kg Gas Bottle (Space for 2nd)
- Twin Coil Calorifier

LIVING SPACE

- Large Open Space ready for furniture
- Carpet Flooring
- TV Bracket , Ariel and Cables
- Twin Side Doors

BATHROOM

- Jabsco Macerator Toilet
- Vanity Basin
- Slipper Bath with shower over
- Cabinet
- Vinyl Flooring

GALLEY

- Spinflo Caprice Oven (new)
- Shoreline Fridge and Freezer
- Zanussi Washer/Dryer
- AEG Dishwasher
- Zanussi Microwave
- Laminate Worktop
- Storage Cupboards over & under
- Tile splashback

BEDROOM

- Fixed Double Bed
- Single Low wardrobe & shelves
- Overhead shelf and lighting

MAINTENANCE

- Full Survey Dec 2024
- BSS Expires Oct 2026

FRONT CABIN

- Cleared Front Cabin
- Storage Shelves
- Carpet

EXTERNAL

- Sound Paintwork
- Front and Rear Covers
- Rear Seating and Table

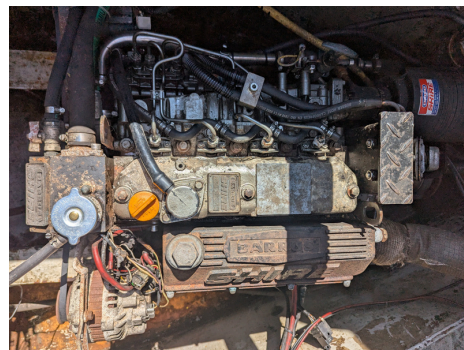

These details are given in good faith but no guarantee is given or implied. Purchasers must satisfy themselves as to the condition and suitability of this vessel. We recommend that a qualified surveyor is employed. The Ashby Canal Centre are agents for this boat on behalf of the owner



